

PALLET SIZE: 660x660x8mm
Model SPM 26

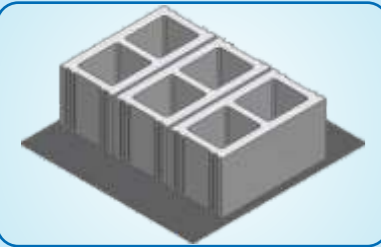

Hollow /
Solid Block
400x200x200mm
(3) at a time
7,500 per 8 hours*

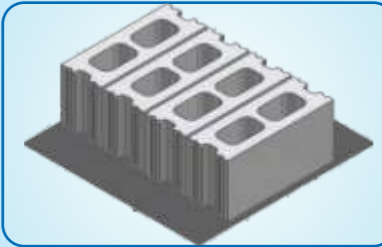

Hollow / Solid
Block
400x150x200mm
(4) at a time
10,000 per 8 hours*

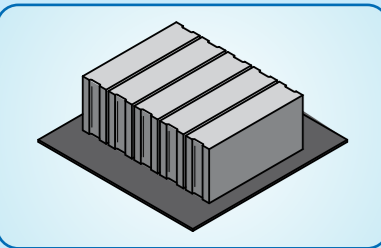

Hollow /
Solid Block
400x100x200mm
(5) at a time
12,500 per 8 hours*



Rectangular
Brick Paver
200x100x100mm
(15) at a time
30,000 per 8 hours*

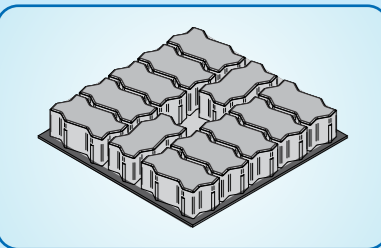

Unistone Paver
225x112.5x100mm
(12) at a time
24,000 per 8 hours*

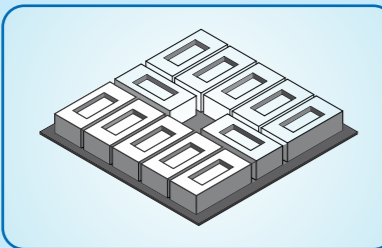

Flyash Brick
230x110x70mm
(12) at a time
30,000 per 8 hours*

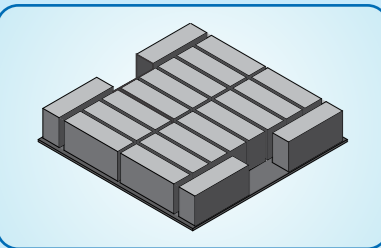

Flyash Brick (On Edge)
230x110x70mm
(20) at a time
50,000 per 8 hours*

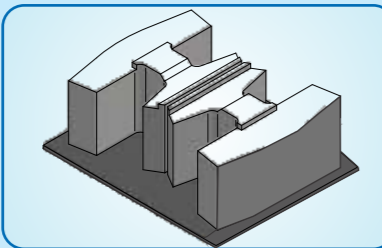

Retaining
Wall Block
450x300x200mm
(2) at a time
4,000 per 8 hours*



Columbia
MACHINE ENGINEERING (I) PVT. LTD.

The Three-Block Machine That Sets
the Quality Standard for the Industry

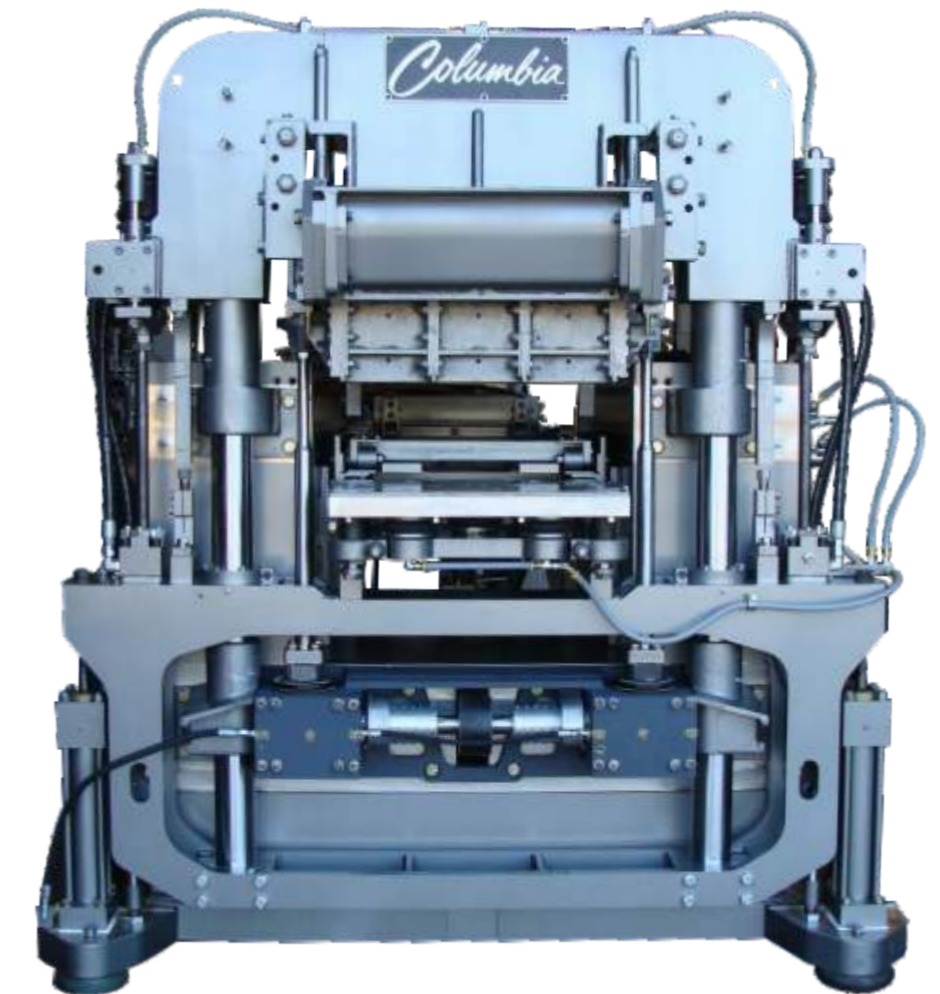

Columbia
MACHINE ENGINEERING (I) PVT. LTD.

1, Rahimtoola House, 7, Homji street,
Fort, Mumbai - 400 001, India.
Phone: +91-22-6743 4330 -31
Email: info@colmac.in, sales@colmac.in
www.colmac.in, www.colmac.com
A Subsidiary of Columbia Machine, Inc. USA



CONCRETE PRODUCT SOLUTIONS
MODEL SPM 26

www.colmac.in

*@ 85% Production efficiency

CONCRETE BLOCK PLANT

Model SPM 26

- Excellent productivity
- Field-proven technology
- Excellent reliability, durability and performance
- Superior accuracy in all products
- Advanced vibration system
- 50% longer mold life

Model SPM 26 Concrete Block Plant Specifications

ITEM	DESCRIPTION	POWER (KW)
1.1	Aggregate Weigh Batching Plant 4 Bin of 10 cu.m. each for storage of aggregates and sand and to automatically weigh and batch on gathering belt conveyor	6.4
1.3	Cement Feeding and Batching System Screw Conveyor for feeding Cement automatically from Holding Hopper/ Silo to Cement Weigh Batcher	5.5
1.4	Inclined Aggregate Belt Conveyor Designed to convey aggregates and sand from weigh batching plant to mixer	5.5
1.5	Planetary/ Pan Mixer Designed to mix aggregates sand and cement with output of 1 cu.m. of concrete per batch	31.5
2.1	Inclined Mud Belt Conveyor Designed to feed Concrete Mix from the mixer to SPM 26 Concrete Block Machine	5.5
2.2	Model SPM 26 Concrete Block Machine Designed to produce concrete products on steel pallets of size 660x660 mm	43.9
2.3	Green Product Rollaway Designed to receive pallets of green products from Machine and hold for loading into curing racks	1.1
2.4	Hydraulic Offbearer with Support Structure Designed to pick up two pallet load of products at a time for loading into curing racks	-
3.1	Pallet Return System PRS consists of Hydraulic Off Bearer to feed pallets with cured products on Cured Product Rollaway for stacking or cubing, Product Push off to push products off pallets, Product Discharge Conveyor to feed cured products for Cubing/ Stacking, Pallet Return Conveyor to return pallets into SPM26 Machine after cleaning and oiling.	8.13
3.3	Plate Style Cuber For end of line automatic Cubing of cured products, with discharge conveyor.	22

Model SPM 26

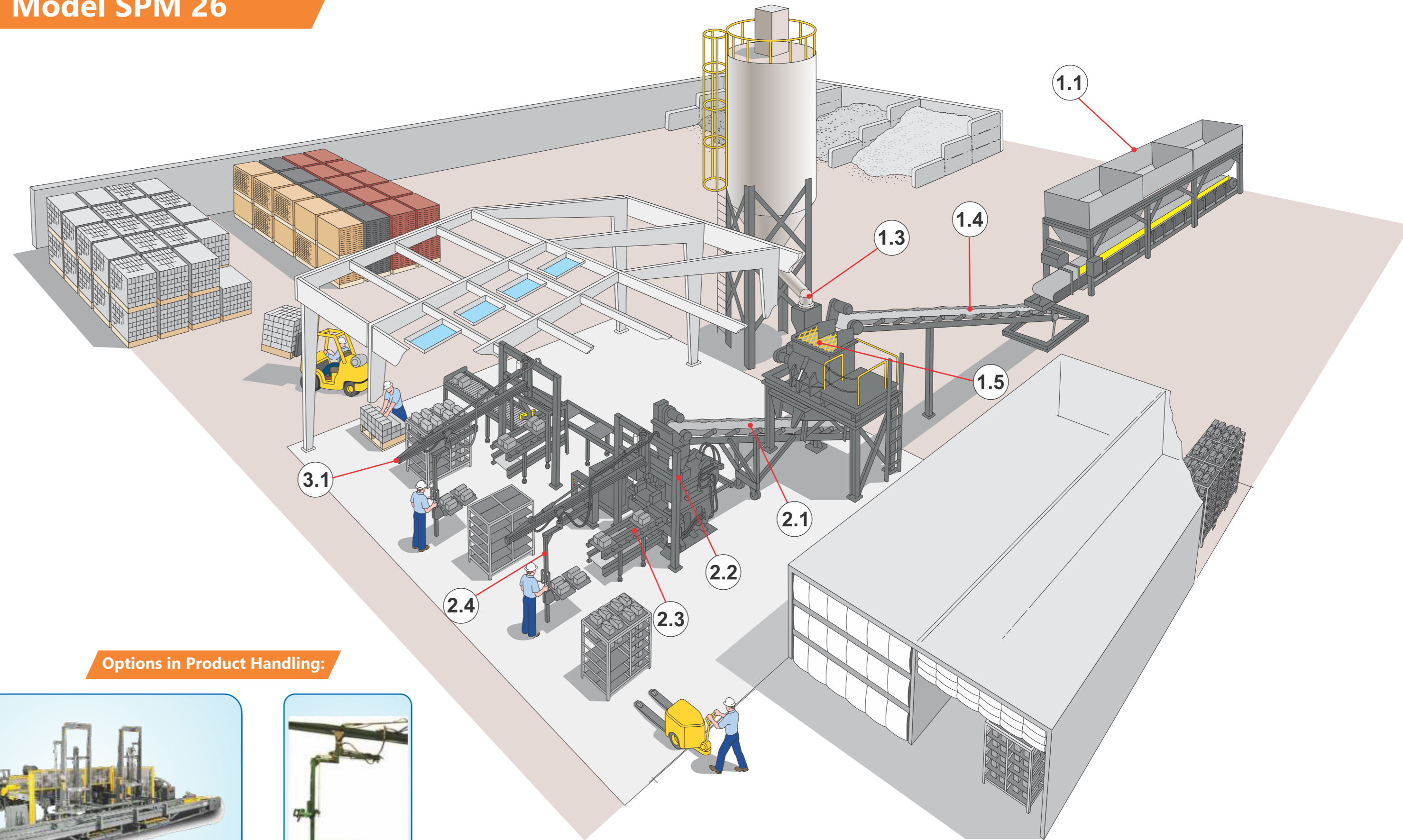

Options in Product Handling:



Automatic Plant with Rack Loader/Unloader and Cuber



With Hydraulic Offbearer